



*We Move with your Conveyor...*

# Thermo Plastic Slat chains

## 820 SERIES

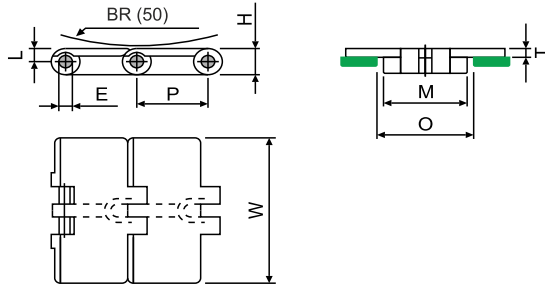

Plate Material : LF Acetal

Pin Material : Austenitic Steel

DIMENSION	MM	Inch
P	38.1	1.50
M	42.1	1.65
L	7.20	0.28
H	13.5	0.53
E	6.35	0.25
T	4.00	0.18
O	44.5	1.73

Standard length : 80 pitches  
(10feet - 3.048 m)

Part No.	Width		Weight (kg/m)
	(mm)	(inch)	
820 K250	63.5	2.50	0.73
820 K325	82.5	3.25	0.83
820 K330	83.8	3.30	0.85
820 K350	88.9	3.50	0.87
820 K400	101.6	4.00	0.95
820 K450	114.3	4.50	1.03
820 K600	152.4	6.00	1.25
820 K750	190.5	7.50	1.47

## 821 SERIES

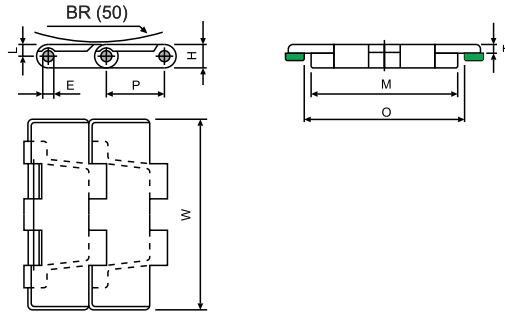

Plate Material : LF Acetal

Pin Material : Austenitic Steel

DIMENSION	MM	Inch
P	38.1	1.50
M	136.5	5.37
L	7.90	0.31
H	14.3	0.56
E	7.90	0.31
T	4.80	0.18
O	140	5.51

Part No.	Width		Weight (kg/m)
	(mm)	(inch)	
821 K750	190.5	7.5	2.50
821 K1000	254.0	10	2.95
821 K1200	304.8	12	3.25

Standard length : 80 pitches  
(10feet - 3.048 m)

## 880 TAB SERIES

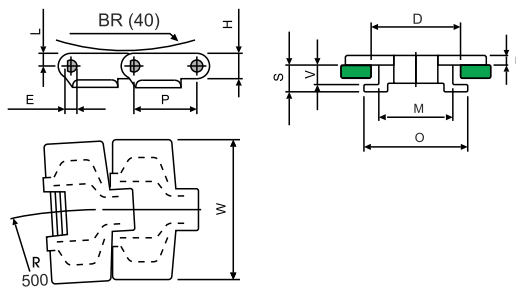

Plate Material : LF Acetal

Pin Material : Austenitic Steel

DIMENSION	MM	Inch
P	38.1	1.50
O	61.1	2.40
L	7.60	0.30
H	20.0	0.78
E	7.10	0.28
T	4.00	0.15
V	11.50	0.45
S	16.0	0.63
M	42.9	1.68
D	45.0	1.77

Part No.	Width		Weight (kg/m)
	(mm)	(inch)	
880TAB K325	82.5	3.25	0.64
880TAB K450	114.3	4.50	1.08

Standard length : 80 pitches  
(10feet - 3.048 m)

## 880M SERIES

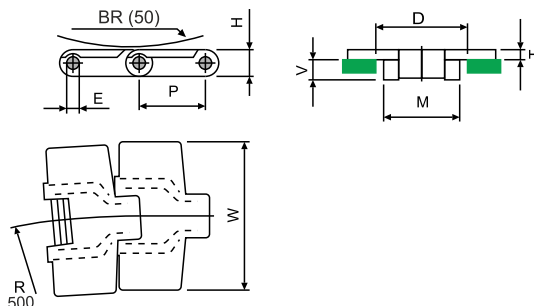

Plate Material : LF Acetal

Pin Material : Martensitic Steel

DIMENSION	MM	Inch
P	38.1	1.50
M	42.1	1.65
L	11.0	0.43
H	15.0	0.59
E	7.10	0.28
T	4.00	0.15
O	44.0	1.73

Part No.	Width		Weight (kg/m)
	(mm)	(inch)	
880 M K325	82.5	3.25	1.03
880 M K450	114.3	4.50	1.16

Standard length : 80 pitches  
(10feet - 3.048 m)

## 882 TAB SERIES

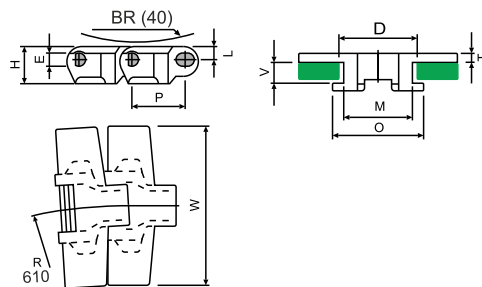

Plate Material : LF Acetal

Pin Material : Austenitic Steel

DIMENSION	MM	Inch
P	38.1	1.50
O	76.2	3.00
L	9.50	0.37
H	27.0	1.06
E	8.70	0.34
T	4.80	0.18
V	17.0	0.66
M	57.2	2.25
D	58	2.28

Part No.	Width		Weight (kg/m)
	(mm)	(inch)	
882TAB K600	152.4	6.0	2.10
882TAB K750	190.5	7.5	2.47
882TAB K1000	254.0	10	2.87
882TAB K1200	304.8	12	3.41

Standard length : 80 pitches  
(10feet - 3.048 m)

# UHMWPE WEAR STRIPS AND GUIDES

<p><b>L1</b></p>	<p><b>Z3</b></p>	<p><b>Z4</b></p>	<p><b>B1</b></p>	<p><b>B2</b></p>
<p><b>B3</b></p>	<p><b>B4</b></p>	<p><b>B5</b></p>	<p><b>W1</b></p>	<p><b>W4</b></p>
<p><b>W5</b></p>	<p><b>W7</b></p>	<p><b>C2</b></p>	<p><b>C7</b></p>	<p><b>C9</b></p>
<p><b>C15</b></p>	<p><b>C17</b></p>	<p><b>D3</b></p>	<p><b>D6</b></p>	<p>Profile : 40 X 10 40 X 8</p> <p><b>D7</b></p>
<p>Profile : 40 X 10 40 X 8</p> <p><b>D8</b></p>	<p>Profile : 40 X 10 40 X 8</p> <p><b>D9</b></p>	<p><b>D10</b></p>	<p><b>I1</b></p>	<p><b>I2</b></p>
<p><b>I3</b></p>	<p><b>I4</b></p>	<p><b>T1</b></p>	<p><b>T2</b></p>	<p><b>T3</b></p>
<p><b>U1</b></p>	<p><b>N28</b></p>	<p><b>N35</b></p>	<p><b>N15</b></p>	<p><b>N14</b></p>

## FRAMES SUPPORTS

Material-Reinforced Polyamide  
Hardware -Stainless Steel



CONNECTING JOINT  
(PART NO. SCJ - 1284)

Bore Dia Meter : 48.5 mm  
Cross Beam Dia : 42.0 mm



ARTICULATED LEGPAD  
(PART NO. SBT - 1680,16100, 16125)

Base Dia : 80 / 100 / 125 mm  
Tailor Made studs can be supplied



SQUARE PIPE ADAPTOR

Square Sizes : 30 / 40 / 50  
Thread Sizes : M12, M16, M20



ROUND PIPE ADAPTOR

Round Sizes : 30 / 40 / 50  
Thread Sizes : M12, M16, M20

## SIDE BRACKETS



PART NO. SB-KB-240



PART NO. SB-KB-210



PART NO. SB-ST-250



PART NO. SB-LB-200

## GUIDE RAIL CLAMPS



PART NO. SRC - 5835 (Dia 10,12)



PART NO. DRC - 5836



PART NO. SRC 2737



PART NO. SRC - 2738 (Dia 12)



PART NO. SRC 2739 (Dia 18)



PART NO. DRC - 6750 (Dia 10)



PART NO. DRC - 9160 (Dia 12)



PART NO. SRC - 9764

## CONNECTING CLAMPS



PART NO. TC - 5630



PART NO. CC - 5220



PART NO. SC - 5830

## RETURN ROLLERS



## CORNER TRACK



Suitable for 880,881 TAB  
 Material : UHMWPE  
 No. of Rows : 1 to 6 Rows



Suitable for 880 M, 881 M,  
 Material : UHMWPE  
 No. of Rows : 1 to 6 Rows

## FRAMES SUPPORTS

Material-Reinforced Polyamide  
 Hardware -Stainless Steel

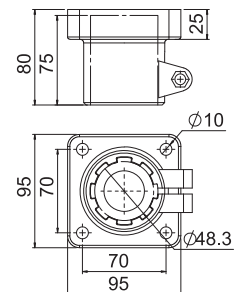
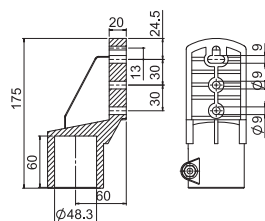
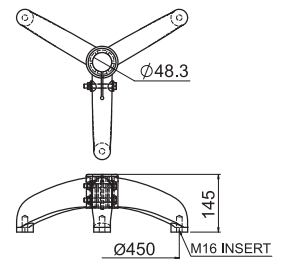
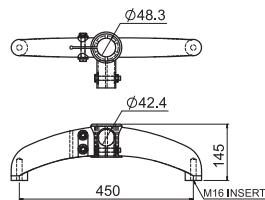

## MODULAR BELTS



SP - OPB (Flat Top)  
Pitch 50.8 mm



SP - OPB (18%)  
Pitch 50.8 mm



SP - OPB (23%)  
Pitch 50.8 mm



SP - OPB (36%)  
Pitch 50.8 mm



SP - OPB (Raised Rib)  
Pitch 50.8 mm



SP - MPB (Flat Top)  
Pitch 50.8 mm



SP - MPB (18%)  
Pitch 50.8 mm



SP - MPB (23%)  
Pitch 50.8 mm



SP - SMPB (Flat Top)  
Pitch 25.4 mm



SP - 2533 (Flat Top)  
Pitch 25.4 mm



SP - 2533 (Flush Grid)  
Pitch 25.4 mm

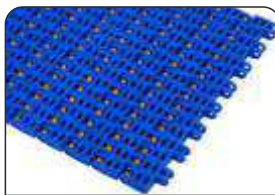

SP - S25 (Flush Grid)  
Pitch 25.4 mm



SP - S500 (Flush Grid)  
Pitch 25.4 mm

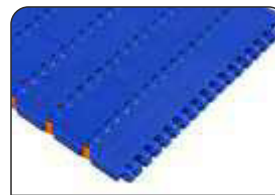

SP - S 900 (Flat Top)  
Pitch 27.2 mm



SP - S 900 (Flush Grid)  
Pitch 27.2 mm



SP - 2120 (Flat Top)  
Pitch 12.7 mm



SP - S12 (Flush Grid)  
Pitch 12.7 mm



SP - S1100 (Flat Top)  
Pitch 15.2 mm



SP - S1100 (Flush Grid)  
Pitch 15.2 mm

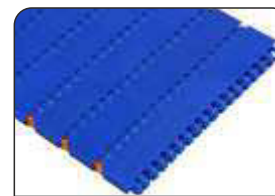

SP - E 30 (Flat Top)  
Pitch 30.0 mm

**Material** : PP / POM

**Operating Temperature** : 0 to 105°C For PP & - 40 to 90°C for POM

Vertical Flights / Cleats & Side Walls can be supplied for Selective Belts

## DRIVE SPROCKETS



For 812 / 815 / 881 M  
No. of Teeth 19 / 21 / 23 / 25



For 881 TAB  
No. of Teeth 19 / 21 / 23 / 25



For 820  
No. of Teeth 19 / 21 / 23 / 25



For 880 T / 880 M  
No. of Teeth 8 / 10 / 12



For 802 / 821  
No. of Teeth 21 / 25



For 1702  
No. of Teeth 8 / 10 / 12



IDLER WHEEL  
No. of Teeth 19 / 21 / 23 / 25



For OPB  
No. of Teeth 8 / 10



For MPB  
No. of Teeth 8 / 10



For SMPB  
No. of Teeth 12 / 18

# Stainless Steel Slat Chains

## 812 SERIES

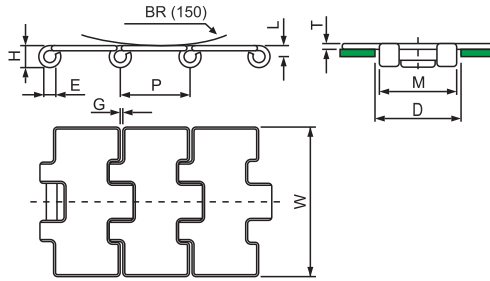

Plate Material : Stainless Steel Pin Material : Martensitic Steel

DIMENSION	MM	Inch
P	38.1	1.50
M	42.0	1.65
L	6.40	0.28
H	13.0	0.51
E	6.40	0.25
T	3.10	0.11
G	1.80	0.06
D	44.0	1.73

Part No.	Width		Weight (kg/m)
	(mm)	(inch)	
812 K325	82.5	3.25	2.5
812 K350	88.9	3.50	2.7
812 K400	101.6	4.00	3.0
812 K450	114.3	4.50	3.3
812 K600	152.4	6.00	4.3
812 K750	190.5	7.50	5.2

Standard length : 80 pitches  
(10feet - 3.048 m)

## 802 SERIES

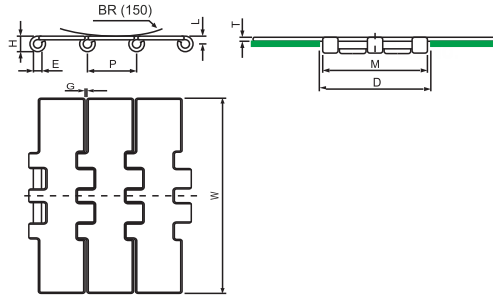

Plate Material : Stainless Steel Pin Material : Martensitic Steel

DIMENSION	MM	Inch
P	38.1	1.5
M	80	3.15
L	6.4	0.25
H	13.0	0.51
E	6.4	0.25
T	3.1	0.12
G	1.8	0.07
D	82.5	3.24

Part No.	Width		Weight (kg/m)
	(mm)	(inch)	
802 K750	190.5	7.50	5.40

Standard length : 80 pitches  
(10feet - 3.048 m)

## 881TAB SERIES

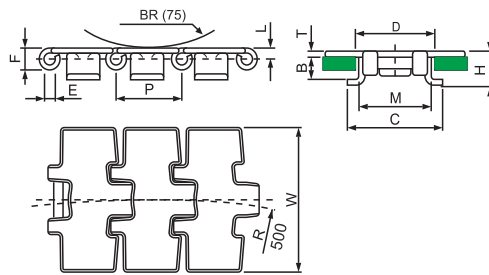

Plate Material : Stainless Steel Pin Material : Martensitic Steel

DIMENSION	MM	Inch
P	38.1	1.50
L	6.40	0.25
H	19.3	0.76
E	6.40	0.25
T	3.10	0.12
C	56.6	0.45
B	12.8	0.50
M	43.0	1.69
F	13.0	0.51
D	45.0	1.77

Part No.	Width		Weight (kg/m)
	(mm)	(inch)	
881TAB K325	82.5	3.25	3.0
881TAB K450	114.3	4.50	3.7
881TAB K750	190.5	7.50	5.5

Standard length : 80 pitches  
(10feet - 3.048 m)

## 881M SERIES

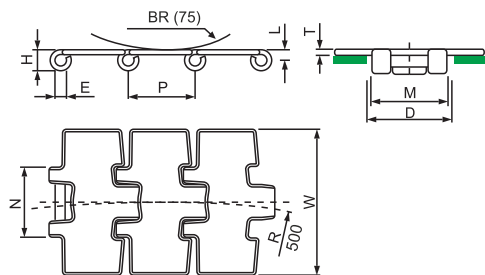

Plate Material : Stainless Steel Pin Material : Martensitic Steel

DIMENSION	MM	Inch
P	38.1	1.50
M	42.0	1.65
L	6.40	0.25
H	13.0	0.51
E	6.40	0.25
T	3.10	0.12
D	44.0	1.73

Part No.	Width		Weight (kg/m)
	(mm)	(inch)	
881M K325	82.5	3.25	2.60
881M K450	114.3	4.50	3.10
881M K750	190.5	7.50	4.90

Standard length : 80 pitches  
(10feet - 3.048 m)

## 815 SERIES

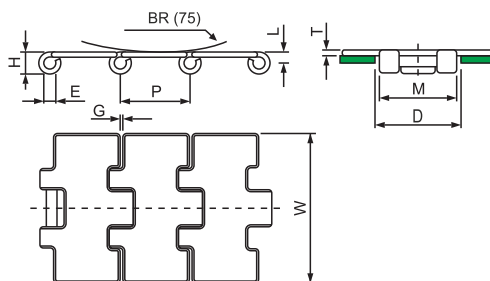

Plate Material : Stainless Steel Pin Material : Martensitic Steel

DIMENSION	MM	Inch
P	38.1	1.50
M	42.0	1.65
L	6.40	0.28
H	13.0	0.51
E	6.40	0.25
T	3.00	0.11
G	1.80	0.06
D	44.0	1.73

Part No.	Width		Weight (kg/m)
	(mm)	(inch)	
SSE815K325VG	82.5	3.25	2.6
SSE805K750VG	190.5	7.50	5.3

Standard length : 80 pitches  
(10feet - 3.048 m)

## BEARING BLOCK



UCF - FOUR BOLT FLANGED BEARING UNIT



UCFL - TWO BOLT FLANGED BEARING UNIT



UCFB - SIDE FLANGED BEARING UNIT



UCT-TAKE UP UNIT



UCP - PILLOW BLOCK UNITS

## OTHER CHAINS



CRATE CHAIN - 1702



CRATE CHAIN - CC600



FINGER CHAIN



GRIPPER CHAIN



INVERTOR CHAIN

## OTHER RANGES



HINGE



HANDLE

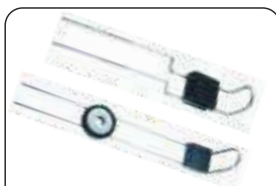

DRIP TRAY CLAMP



GUIDE SHOE



RETURN GUIDE SHOE



TRANSFER COMB



RT114 CHAIN



CAP ELEVATOR CHAIN



RETAINER RING



COMBINER ROLLER

## OUR FACILITY



**SPECTRA PLAST INDIA PVT LTD.,**  
No. 56, Sri Subaganesh Industrial Estate,  
Kuppepalayam (P.O), Annur Taluk,  
Coimbatore - 641 107.

☎ 0422 - 2975529 / 2975872  
✉ sales@spectraplast.in  
🌐 www.systemplast.com,  
www.spectraplast.in